

## 1. GENERAL SAFETY INSTRUCTIONS

**⚠ Please take the time to read these instructions carefully and always keep them in the storage pouch provided (14) on the child seat for later reference. The instructions must accompany the child seat if it is later passed on to a third party.**

### ⚠ DANGER! For the protection of your child:

- Before closing the vehicle door, check that neither your child nor any parts of the child seat can get jammed in the door.
- In the event of an accident at a collision velocity greater than 10 km/h, it is possible that the child seat may be damaged without the damage being immediately visible. In this case the child seat must be replaced. Please dispose of it properly.
- Always have the child seat examined if it has been damaged (e.g. if it falls to the ground).
- Regularly check all important parts for damage. In particular, ensure that all the mechanical parts are fully functional.
- Never lubricate any parts of the child seat with grease or oil.
- Never leave your child unattended in the child seat in the vehicle.
- Have your child enter and exit the vehicle on the pavement side only.
- When not in use, protect the child seat from direct exposure to sunlight. The child seat can become very hot in direct sunshine. Children's skin is sensitive and could be harmed as a result.
- The more snugly the belt fits over your child's body, the safer your child will be. Therefore, avoid having your child wear thick clothes under the belt.
- On long journeys, take regular breaks in order to give your child a chance to run about and play.
- If using on the rear seat: Move the front seat far enough forward to ensure that your child's feet will not knock against the backrest of the front seat (to prevent the risk of injury).

### ⚠ DANGER! For the protection of all vehicle occupants:

In the case of an emergency stop or accident, unsecured objects or people may cause injury to other occupants in the vehicle. Therefore, please always ensure that ...

- no load-bearing contact points are used other than those specified in these instructions and those marked on the child seat.
- the backrests of the car seats are secured (for example, check that any fold-down rear seat bench has snapped into place).

- all heavy or sharp-edged objects present in the vehicle (e.g. on the parcel shelf) are held securely.
- all persons in the vehicle have their seatbelts fastened.
- the child seat is secured whenever it is in the vehicle, even if it is not carrying a child.

### ⚠ WARNING! For your protection when handling the child seat:

- Never use the child seat in a free-standing position, not even for testing.
- To avoid damage, ensure that the child seat is not jammed in between hard objects (car door, seat rails, etc.).
- Keep the child seat in a safe place when not in use. Do not place heavy objects on the seat and do not store directly next to heat sources or in direct sunlight.

### ⚠ CAUTION! To protect your vehicle:

- Certain car seat covers made from more sensitive materials (e.g. velour, leather, etc.) may show wear marks after a child seat has been used. For optimum protection of your car seat covers, we recommend using the BRITAX RÖMER car seat protector from our range of accessories.

## 2. USE IN THE VEHICLE

Please refer to your vehicle's instruction manual for instructions on how to use child restraint systems. This seat can be used in vehicles with ISOFIX & Top Tether anchorage points, in vehicles with ISOFIX & 3-point harness (see type list) and in vehicles with 3-point harness.

Please refer to your vehicle's instruction manual for information on the seats approved as child seats for weight class 9 to 36 kg.

The ADVANSAFIX IV R is approved for three different installation methods:

Group	Installation method	Approval type	Section of user instructions
1 (9-18 kg)	ISOFIX + Top Tether	universal	A
2/3 (15-36 kg)	ISOFIT + car seat belt	semi-universal <sup>1)</sup>	B1
2/3 (15-36 kg)	Car seat belt	universal	B2

<sup>1)</sup> This means that the child seat may only be used in vehicles listed on the enclosed vehicle type list. This type list is constantly being updated.

The latest version can be obtained from us or from our website at [www.britax.com](http://www.britax.com)

You can install your child seat as follows:

Facing forwards (in the direction of travel)	Yes
Facing backwards (against the direction of travel)	No <sup>1)</sup>
With 2-point harness	No
With 3-point harness <sup>2)</sup>	Yes
with ISOFIX fixing points (between seat surface and backrest)	Yes
On front passenger seat	Yes <sup>3)</sup>
On outer rear seat	Yes
On centre rear seat (with 3-point harness)	Yes <sup>4)</sup>

<sup>1)</sup> Installation is permitted on backward-facing car seats (e.g. in a van or minibus) only if these seats are also approved for carrying adults. The seat must not be within the activated range of an airbag.

<sup>2)</sup> The safety belt must be approved to ECE R 16 (or a comparable standard), which is indicated on the harness test label by an "E" or "e" inside a circle.

<sup>3)</sup> If there is a front airbag: Slide the car seat well back and follow the relevant instructions in the vehicle's instruction manual.

<sup>4)</sup> It cannot be used if there is only a 2-point belt available.

## 3. APPROVAL

BRITAX RÖMER Child seat	Testing and certification In accordance with ECE* R 44/04	
	Group	Body weight
ADVANSAFIX IV R	I+II+III	9 to 36 kg

\*ECE = European Standard for Child Safety Equipment

The child seat has been designed, tested and approved according to the requirements of the European Standard for Child Safety Equipment (ECE R 44/04). The E certification mark (in a circle) and approval number can be found on the orange approval label (sticker on the child seat).

**⚠ DANGER!** The certification is invalidated if you make any modifications to the child seat. Only the manufacturer is permitted to make modifications to the child seat.

**⚠ DANGER!** Never secure your child or the child seat with a 2-point belt. If you secure your child in the child seat with a 2-point belt only, this may cause serious injuries to your child in the event of an accident and could even cause death.

**⚠ WARNING!** The ADVANSAFIX IV R must be used exclusively for securing your child in the vehicle. It is in no way suitable for use as a seat or toy in the home.

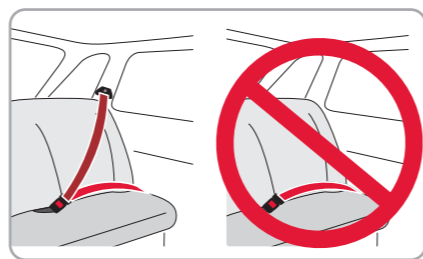

## 4. CARE AND MAINTENANCE

### TAKE CARE OF THE HARNESS BUCKLE

To ensure the safety of your child, it is essential that the harness buckle continues to function correctly. Harness buckle malfunctions are usually caused by dirt accumulation or by external objects. Such malfunctions may be:

- When you press the red release button, the buckle clips are ejected only slowly.
- The buckle clips no longer engage (i.e. they pop out again when you try to push them in).
- The buckle clips do not engage without an audible click.
- The buckle clips are difficult to push in (you feel a certain amount of resistance).
- It takes a lot of force to open the harness buckle.

### Remedy

Rinse out the harness buckle so that it works perfectly again:

### CLEANING THE HARNESS BUCKLE

1. Open the Velcro fastener on the crotch cushion (31) and remove it.
2. Remove the grey release plate (32) as described in Section "11. REMOVING THE 5-POINT HARNESS AND RE-ATTACHING SECUREGUARD".
3. Place the release plate (32) along with the harness buckle (20) in warm water with some washing-up liquid for at least one hour.
4. Thoroughly rinse the harness buckle (20) and dry it completely.
5. Attach the grey release plate (32) as described in Section 11. "REMOVING THE 5-POINT HARNESS AND RE-ATTACHING SECUREGUARD".
6. Attach the crotch cushion (31).

### CLEANING

**⚠ CAUTION** Please ensure that you use only original BRITAX replacement seat covers, as the seat cover is an integral part of the child seat and is important for correct functioning of the system. Replacement seat covers are available from your dealer.

**⚠ CAUTION!** The child seat must not be used without its cover.

- The seat cover can be removed and washed with a mild detergent in a washing machine with the "Delicates" programme (30 °C). Please follow the instructions on the washing label of the seat cover.
- The shoulder cushions can be removed and washed in lukewarm soapy water.
- The plastic parts, belts, and SecureGuard can be cleaned with soapy water. Do not use any aggressive cleaning agents (such as solvents).

### Removing the cover

#### Headrest



1. Open the two press studs (33) at the belt slots.
2. Push the headrest of the child seat to the topmost position.
3. Pull the elastic band up from the edge of the tray and pull the tabs (34) out of the two slots in the seat pan.
4. Pull the cover edge out of the gap between the seat pan and the inlay cushion.
5. Unhook the rubber loops (35) under the headrest.

#### Seat pan



6. Undo the Velcro fastener on the crotch cushion (31) and remove it.
7. Open the four press studs (36) on the seat and back surface.
8. Push the harness buckle (20) or SecureGuard (26) through the cover slot.
9. Unhook the rubber loops (37) at the front under the seat surface and pull the tabs (38) out of the seat pan.
10. Pull the rubber loops carefully out of the gap around the belt guides (28).
11. Pull the cover edge and tabs (39) out of the gap between the seat pan and the inlay cushion.
12. Pull the rubber loops (40) at the top of the back of the backrest out of the gap in the seat pan and unhook them.

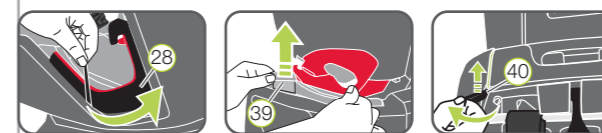

### Reattaching the cover:

Simply follow the steps above in reverse order.

**⚠ CAUTION!** If the child seat is installed with Method A, always install the harness buckle (20) correctly, and if installed with Method B, always install SecureGuard (26) correctly. Make sure that the release plate (45) is correctly attached.

**⚠ CAUTION!** Check that the straps are not twisted and are laid correctly through the slots in the cover. The rear slot in the seat cover is provided for the harness buckle (20) and the front slot is provided for the SecureGuard (26). The slot at the front edge of the seat is for the harness adjusting strap (22).

### Removing the shoulder cushions



1. Loosen the shoulder straps (08) as far as possible.
2. Open the shoulder cushions (19) by the Velcro fasteners at the side.



### Child seat back

3. Bring the top tether (13) forward over the front of the seat.
4. Unhook the storage pouch (14) at the top.
5. Pull out the shoulder straps (08) a little so that you can see the rubber loops of the shoulder cushions (19) underneath.
6. Unhook the rubber loops from the plastic bars (41) on the shoulder strap height adjuster (42).
7. Pull the shoulder cushions (19) forwards out of the harness slots.

### Reattaching the shoulder cushions

Simply follow the steps above in reverse order.

**⚠ CAUTION** The shoulder cushions (19) and belts must not be twisted or swapped over. The shoulder straps (08) must be located under the black cover band (43) in the shoulder cushions (19).

## 11. REMOVING THE 5-POINT HARNESS AND RE-ATTACHING SECUREGUARD



We recommend using the 5-point harness as long as possible and making the conversion only when your child starts to weigh more than 15 kg and has reached the highest position of the headrest.

1. Loosen the 5-point harness on the child seat as far as possible (09).
2. Open the harness buckle (20) and place the belt clips (21) in the belt guides on the sides.
3. Loosen the press studs on the backrest and fold the upper half of the cover upwards and the lower half downwards.
4. Insert the belt clips (21) in the recess provided on the (44) inside of the backrest.

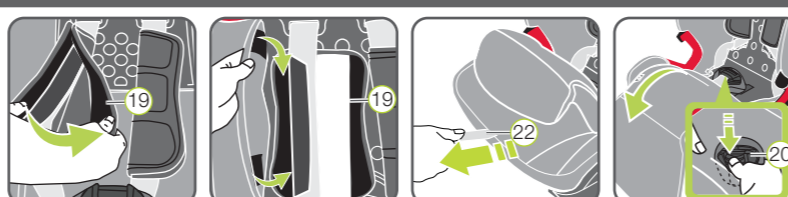

5. Open the two shoulder cushions (19) by the Velcro fasteners on the side.
6. Push the Velcro strip of the two opened shoulder cushions (19) under the backrest cover and attach it to the fleece strip provided. Check that the two shoulder cushions are not overlapping.
7. Pull the adjusting strap (22) to tighten the harness.
8. Release the two press studs on the seat cover and fold the cover forwards. While doing this, pull the harness buckle (20) out of the cover.
9. Raise the grey release plate (32) and push it along with the harness buckle (20) towards the backrest (30).

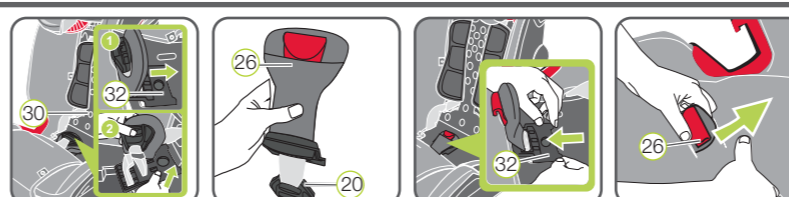

10. Turn the grey release plate around (32) so that the SecureGuard (B) (26) is at the top and the harness buckle (A) (20) is at the bottom.
11. Stow the harness buckle (20) in the recess provided and push the grey release plate (32) back into the holder until it engages with an audible click.
12. Pass the SecureGuard (26) through the slot in the cover with so-w-on B.
13. Close the two bottom press studs on the cover.
14. Close the two top press studs on the cover.
15. Close the two press studs on the upper cover of the headrest.

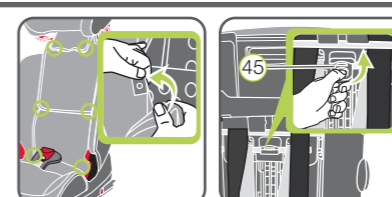

### Child seat back

16. Press the safety catch at the centre of the group change switch (45), at the same time moving it to the upper position for use with Group 2/3 (15-36 kg).

## 12. RE-ATTACHING THE 5-POINT HARNESS AND REMOVING SECUREGUARD

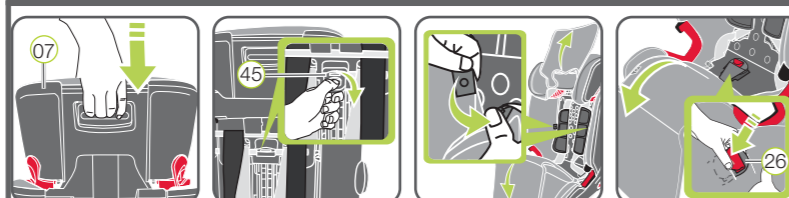

### Child seat back

1. Slide the headrest (07) to the lowest position.
2. Press the safety catch at the centre of the group change switch (45), at the same time moving it to the lower position for use with Group 1 (9-18 kg).

### Child seat front

3. Fold the lower part of the headrest cover upwards and lay it over the headrest.
4. Open the two press studs on the inside of the headrest cover.
5. Release the two press studs on the back of the cover.

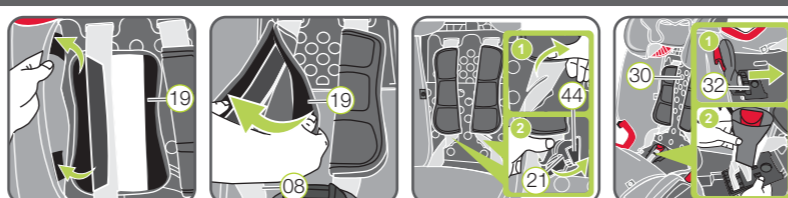

6. Release the two press studs on the seat cover and fold the cover forwards. When doing so, pull the SecureGuard (26) out of the cover.
7. Loosen the 5-point harness (09) on the child seat as far as possible. Tip: Pull the two shoulder straps forward while pressing the adjustment button (18).
8. Release the two opened shoulder cushions (19) from the Velcro strip and fold them around the shoulder straps (08).

**⚠ DANGER** Make sure that the shoulder straps (08) pass correctly through the shoulder cushions (19).

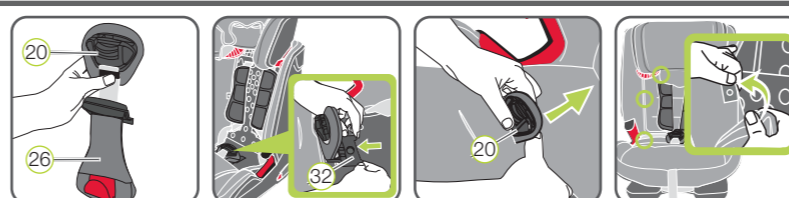

9. Remove the belt clips (21) from the recess provided on the (44) inside of the backrest.
10. Raise the grey release plate (32) and push it along with the SecureGuard (26) towards the backrest (30).
11. Turn the grey release plate (32) around so that the harness buckle (20) is at the top and the SecureGuard (26) is at the bottom.
12. Store the SecureGuard (26) in the recess provided and push the grey release plate (32) back into its holder until it engages with an audible click.
13. Pass the harness buckle (20) through the slot in the cover which is nearer to the backrest.

14. Close the two bottom press studs on the cover.
15. Close the two top press studs on the cover.
16. Close the two press studs on the upper cover of the headrest.

### BRITAX RÖMER Child Safety EMEA

[www.britax-roemer.com](http://www.britax-roemer.com) | [hello@britax-roemer.com](mailto:hello@britax-roemer.com)

BRITAX RÖMER Kindersicherheit GmbH  
Theodor-Heuss-Straße 9  
89340 Leipheim  
Germany  
+49 (0) 8221 3670 199

BRITAX Excelsior Limited  
1 Churchill Way West  
Andover  
Hampshire SP10 3UW  
United Kingdom  
+44 (0) 1264 386034

BRITAX Nordiska Barn AB  
Jörgen Kocksgatan 4  
SE-211 20 Malmö  
Sweden



## 5. PREPARATORY STEPS

First please read the section describing the desired installation method in Section 6.

### 5.1 Preparing ISOFIX

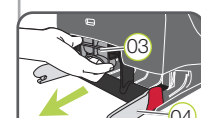
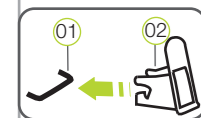

\* The insertion aids make it easier to install the child seat using the ISOFIX fixing points and they prevent damage to the car seat covers. If they are not being used, remove them and keep them in a safe place. For vehicles with a folding backrest, the insertion aids need to be removed before folding the backrest.  
Any problems that occur are usually caused by dirt or external objects on the insertion aids and on the hook. Remove the dirt or external objects to resolve such problems.

### 5.2 Adjusting the headrest for Group I (9-18 kg)

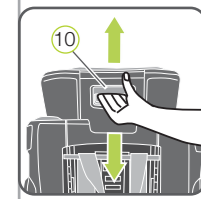
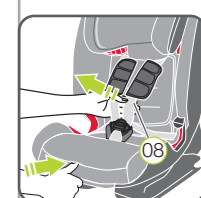

### 5.3 Adjusting the headrest for Group II +III (15-36 kg)

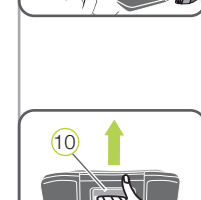

- If your vehicle is not fitted with ISOFIX insertion aids as standard, clamp the two insertion aids (02) (which are supplied along with the seat), with recess facing upwards, into the two ISOFIX fixing points (01) in your vehicle.  
**TIP:** The ISOFIX fixing points are located between the seat surface and the backrest of the car seat.
- Move the headrest of the car seat to its topmost position.
- Pull the grey handle (03) at the back of the child seat until the ISOFIX locking arms (04) are fully extended.
- On both sides of the ISOFIX locking arms, squeeze the (04) green locking button (05) and the red release button (06) together. This ensures that both hooks on the ISOFIX locking arms (04) are open and ready to use.

A properly adjusted headrest (07) ensures optimal protection for your child in the child seat. Regularly check that the height of the headrest (07) is suitable for the body height of your child: The headrest (07) must be adjusted so that the shoulder straps (08) are at the same level as your child's shoulders, or slightly higher.

- The shoulder straps (08) must be adjusted so that they are horizontal or just above your child's shoulders.
- The shoulder straps (08) must not be passed behind the child's back, or placed level with or above the child's ears.

#### The shoulder straps are adjusted as follows:

- Loosen the 5-point harness (09) on the child seat as far as possible.
- Press and hold the adjustment handle (10) on the back of the headrest (07).
- The unlocked headrest (07) can now be moved to the desired height. When you release the adjustment handle (10), the headrest (07) locks into place.

#### To adjust the height of the headrest to fit your child:

- Press and hold the adjustment handle (10) on the back of the headrest (07).
- The headrest (07) is now unlocked and can be moved to the desired height. When you release the adjustment handle (10), the headrest (07) locks into place.
- Place the child seat on the car seat.
- Sit your child on the child seat and check the height. Repeat this procedure until the headrest (07) is at the correct height.

## 6. INSTALLATION & USE

### A GROUP 1 (9-18 kg) With ISOFIX + Top Tether

#### 1. PREPARATORY STEPS

- 1.1 Follow the steps described in Section 5.1 "PREPARING ISOFIX".
- 1.2 Follow the steps in Section 5.2 "ADJUSTING THE HEADREST FOR GROUP I".

#### 2. PREPARING THE TOP TETHER

- 2.1 Unhook the snap-on hook (12) of the top tether (13) from the fastening on the back of the child seat.
- 2.2 Take the top tether (13) out of the pouch (14) and lay it over the child seat.  
**TIP:** Remove the outer rubber band only if the length of the top tether (13) is not sufficient for your vehicle model.
- 2.3 Place the child seat in the direction of travel on an approved car seat. Adjust the backrest angle of the car seat so that the gap between the car seat and the child seat is as small as possible.
- 2.4 Take the top tether (13) and press the metal tongue (15) away from the belt to extend it, and pull the top tether (13) at the snap-on hook (12).
- 2.5 Guide the top tether (13) in the middle between the bars of the headrest (07), for integrated headrests on the side closer to the top tether (13) anchorage point of the vehicle.

#### 3. FIXING THE TOP TETHER

Attach the snap-on hook (12) to the anchorage point recommended in your vehicle's instruction manual.  
**CAUTION!** Check that you are not using luggage hooks instead of the top-tether anchorage points.  
Look for the following symbol in your vehicle:

#### 4. FASTENING THE ISOFIX

- 4.1 Position the two ISOFIX locking arms (04) directly in front of the two insertion aids (02).
- 4.2 Push the two ISOFIX locking arms (04) into the insertion aids (02) until the ISOFIX locking arms (04) engage on both sides with an audible click.  
**DANGER!** The green locking button (05) must be visible on both sides indicating that the child seat is correctly fastened.

#### 5. PRESS THE CHILD SEAT BACKWARDS

Push the child safety seat firmly backwards as far as it will go.

#### 6. CHECK FOR CORRECT FASTENING

Shake the child seat to check that it is securely fastened and check the locking buttons (05) to make sure that the two indicators are fully green.

#### 7. TIGHTEN THE TOP TETHER

Tighten the top tether (13), until the belt tension indicator (16) turns green and the top tether (13) is tight.

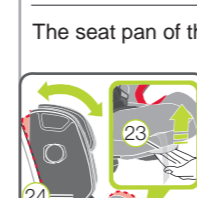
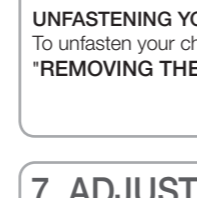
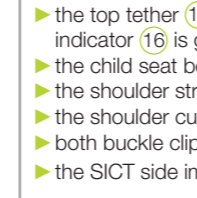
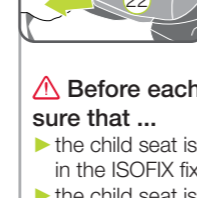
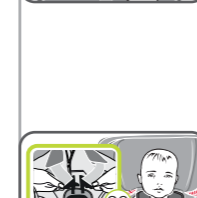
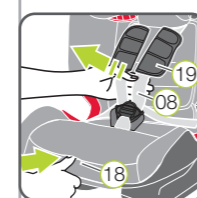
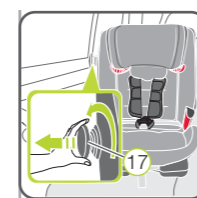
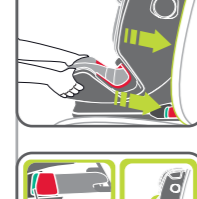
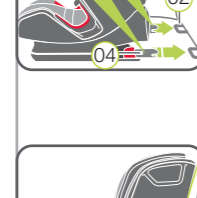
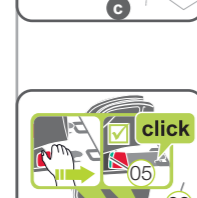
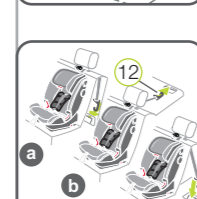
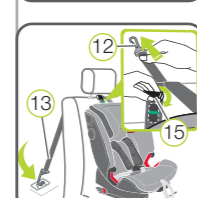
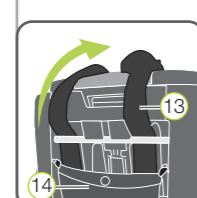
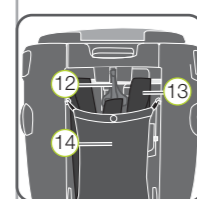

#### 8. ADJUSTING THE SICT

Turn the SICT (17) anti-clockwise (on the side nearer the vehicle door) until there is a gap of 5 mm between it and the vehicle door, or until it is fully unscrewed.

#### 9. LOOSEN THE SHOULDER STRAPS

To loosen the shoulder straps, press the adjustment button (18) while at the same time pulling both shoulder straps (08) forward.  
**CAUTION!** Do not pull the shoulder cushions (19).

#### 10. OPEN THE HARNESS BUCKLE

To open the harness buckle (20) press the red button on the buckle.

#### 11. SET THE CHILD IN THE CHILD SEAT

Place your child in the child seat.  
Check that the harness buckle (20) is facing forwards.

#### 12. PLACE THE SHOULDER STRAPS

Pass the shoulder straps (08) over your child's shoulders.  
**WARNING!** Do not twist or swap the shoulder straps, as this will remove their protective function.

#### 13. FASTENING THE HARNESS BUCKLE

Take the two buckle clips (21) and hold them together before inserting them in the harness buckle (20) – they must make an audible click when inserted.

#### 14. TIGHTENING THE ADJUSTMENT STRAP

Pull the adjustment strap (22) until the strap lies flat and snug around your child's body.

**WARNING!** The hip belts must be positioned as low as possible across your child's hips.

**Before each journey, in order to ensure your child's safety, make sure that ...**

- the child seat is engaged on both sides with the ISOFIX locking arms (04) in the ISOFIX fixing points (01) and that both locking buttons (05) are fully green;
- the child seat is securely fastened;
- the top tether (13) is tight over the backrest of the car seat and the belt tension indicator (16) is green;
- the child seat belts fit snugly around the child's body without causing constriction;
- the shoulder straps (08) are correctly adjusted and are **not** twisted;
- the shoulder cushions (19) are in the correct position for your child's body;
- both buckle clips (21) are fully engaged in the harness buckle (20);
- the SICT side impact protection (17) is correctly installed and functional.

#### UNFASTENING YOUR CHILD AND REMOVAL:

To unfasten your child or to remove the child seat, follow the steps in Section 9 "REMOVING THE CHILD SEAT".

## 7. ADJUSTING THE SEAT ANGLE

The seat pan of the ADVANSAFX IV R has three different angles of tilt:

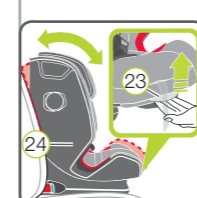

#### To adjust the seat angle:

Pull the adjustment handle (23) forwards and push/slide the seat pan (24) into the desired position.

**DANGER!** The seat pan (24) must be firmly engaged, whatever the position. Pull on the seat pan (24) to check that it has engaged.

**TIP:** You can adjust the tilt angle of the child seat (24) even while your child is sitting on it.

### B1 GROUP 2 (15-25 kg) & GROUP 3 (22-36 kg) With ISOFIT + car seat belt

#### 1. PREPARATORY STEPS

- 1.1 Follow the steps described in Section 5.1 "PREPARING ISOFIX".
- 1.2 Follow the steps in Section 5.3 "ADJUSTING THE HEADREST FOR GROUP II+III".

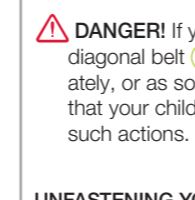
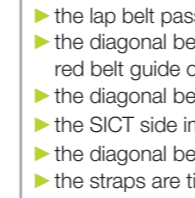
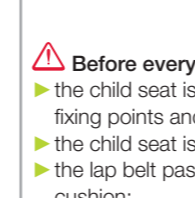
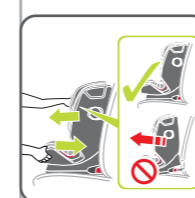
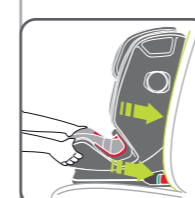

#### UNFASTENING YOUR CHILD AND REMOVAL:

To unfasten your child or to remove the child seat, follow the steps in Section 9 "REMOVING THE CHILD SEAT".

**DANGER!** If your child tries to open the car seat belt buckle (27) or insert the diagonal belt (11) in the bright red SecureGuard (26), stop your vehicle immediately, or as soon as possible. Check that the child seat is correctly fastened and that your child is correctly secured. Explain to your child the dangers caused by such actions.

To unfasten your child or to remove the child seat, follow the steps in Section 9 "REMOVING THE CHILD SEAT".

### B2 GROUP 2 (15-25 kg) & GROUP 3 (22-36 kg) With car seat belt

The ADVANSAFX IV R is not permanently installed in the vehicle. It is simply secured along with your child by the vehicle's 3-point seat belt.



#### Before every journey, for your child's safety, check that ...

- the child seat is securely fastened;
- the lap belt (25) passes through the bright red belt guides (28) on both sides of the seat cushion;
- the lap belt (25) passes through the bright red SecureGuard (26);
- the diagonal belt (11) on the side of the car seat belt buckle (27) also passes through the bright red belt guide (28) on the seat cushion;
- the diagonal belt (11) passes through the dark red belt holder (29) at the headrest;
- the diagonal belt (11) runs diagonally backwards;
- the straps are tight and **not** twisted;
- the SICT side impact protection (17) is correctly installed and functional;
- the car seat belt buckle (27) is **not** placed in the bright red belt guide (28) on the seat cushion.

**DANGER!** If your child tries to open the car seat belt buckle (27) or insert the diagonal belt (11) in the bright red SecureGuard (26), stop the vehicle immediately, or as soon as possible. Check that the child safety seat is correctly fastened and that your child is correctly secured. Explain to your child the dangers caused by such actions.

#### UNFASTENING YOUR CHILD AND REMOVAL:

To unfasten your child or to remove the child seat, follow the steps in Section 9 "REMOVING THE CHILD SEAT".

## 8. SECURING YOUR CHILD

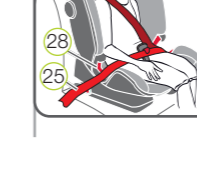
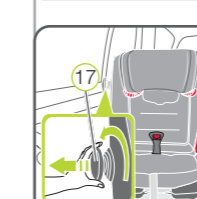

- Follow the steps in Section 8 "ADJUSTING THE HEADREST FOR GROUP II+III".
- Place the child seat on the car seat. Ensure that the backrest (30) is flat against the backrest of the car seat.  
**TIP:** If the headrest of the car seat prevents the child seat from being fastened properly, it should be removed (see vehicle's instruction manual). Secure the removed headrest in a suitable place in the vehicle so that it will not be tossed around.
- Follow the steps in Section 8 "SECURING YOUR CHILD".

#### Before every journey, for your child's safety, check that ...

- the child seat is securely fastened;
- the lap belt (25) passes through the bright red belt guides (28) on both sides of the seat cushion;
- the lap belt (25) passes through the bright red SecureGuard (26);
- the diagonal belt (11) on the side of the car seat belt buckle (27) also passes through the bright red belt guide (28) on the seat cushion;
- the diagonal belt (11) passes through the dark red belt holder (29) at the headrest;
- the diagonal belt (11) runs diagonally backwards;
- the straps are tight and **not** twisted;
- the SICT side impact protection (17) is correctly installed and functional;
- the car seat belt buckle (27) is **not** placed in the bright red belt guide (28) on the seat cushion.

**DANGER!** If your child tries to open the car seat belt buckle (27) or insert the diagonal belt (11) in the bright red SecureGuard (26), stop the vehicle immediately, or as soon as possible. Check that the child safety seat is correctly fastened and that your child is correctly secured. Explain to your child the dangers caused by such actions.

#### UNFASTENING YOUR CHILD AND REMOVAL:

To unfasten your child or to remove the child seat, follow the steps in Section 9 "REMOVING THE CHILD SEAT".

## 8. SECURING YOUR CHILD



- Turn the SICT (17) anti-clockwise (on the side nearer the vehicle door) until there is a gap of 5 mm between it and the vehicle door or until it is fully unscrewed. Pull out the car seat belt, pass it in front of your child and into the car seat belt buckle (27).  
**DANGER!** Check that the car seat belt is not twisted, otherwise the full protective action of the restraint system will be impaired.
- Insert the buckle clip in the car seat belt buckle (27) until there is an audible click.
- Place the diagonal belt (11) and lap belt (25) on the side of the car seat belt buckle (27) in the bright red belt guide (28) on the seat cushion.  
**DANGER!** The seat belt buckle (27) must not be placed near the bright red belt guide (28).
- Also place the lap belt (25) on the other side of the seat cushion in the light red belt guide (28).  
**DANGER!** The lap belt (25) must be placed as low as possible over your child's hips on both sides.

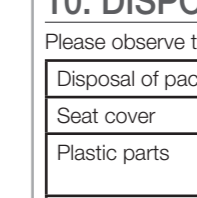
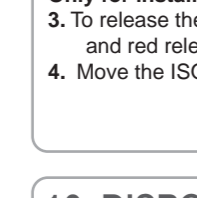
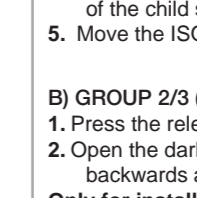
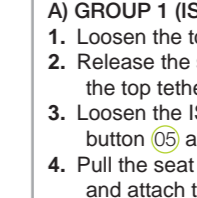
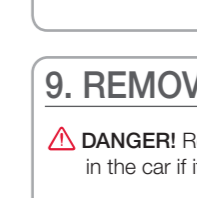
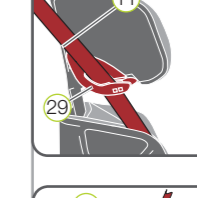
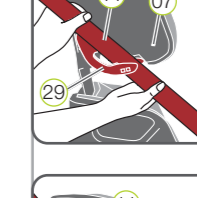
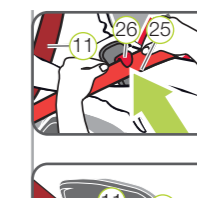

## 9. REMOVING THE CHILD SEAT

**DANGER!** Remove the child seat from the vehicle. Never carry the child seat in the car if it is not fastened properly.

#### A) GROUP 1 (ISOFIX & TOP TETHER)

- Loosen the top tether (13) by pushing the metal tongue (15) away from the belt.
- Release the snap-on hook (12) from the anchorage point in the vehicle and lay the top tether (13) to the front over the child seat.
- Loosen the ISOFIX fastening on both sides by squeezing the green locking button (05) and red release button (06) together.
- Pull the seat forward and store the top tether (13) in the storage pouch (14) and attach the snap-on hook of the top tether (13) to the fastening on the back of the child seat.
- Move the ISOFIX locking arms (04) back into the seat pan (24).

#### B) GROUP 2/3 (ISOFIT & CAR SEAT BELT / CAR SEAT BELT)

- Press the release button on your car seat buckle
- Open the dark red belt holder (29) by pressing the button on the belt holder (29) backwards and pull out the diagonal belt (11).

#### Only for installation method with ISOFIT:

- To release the ISOFIT fastening, squeeze the green locking button (05) and red release button (06) together, first on one side then on the other.
- Move the ISOFIX locking arms (04) back into the seat pan (24).

## 10. DISPOSAL

Please observe the waste disposal regulations in your country.

Disposal of packaging	Container for cardboard boxes
Seat cover	Residual waste, waste incineration
Plastic parts	To be placed in the corresponding container according to the labels
Metal parts	Container for metals
Belt straps	Container for polyester
Buckle and clip	Residual waste