

1. PRODUCT OVERVIEW

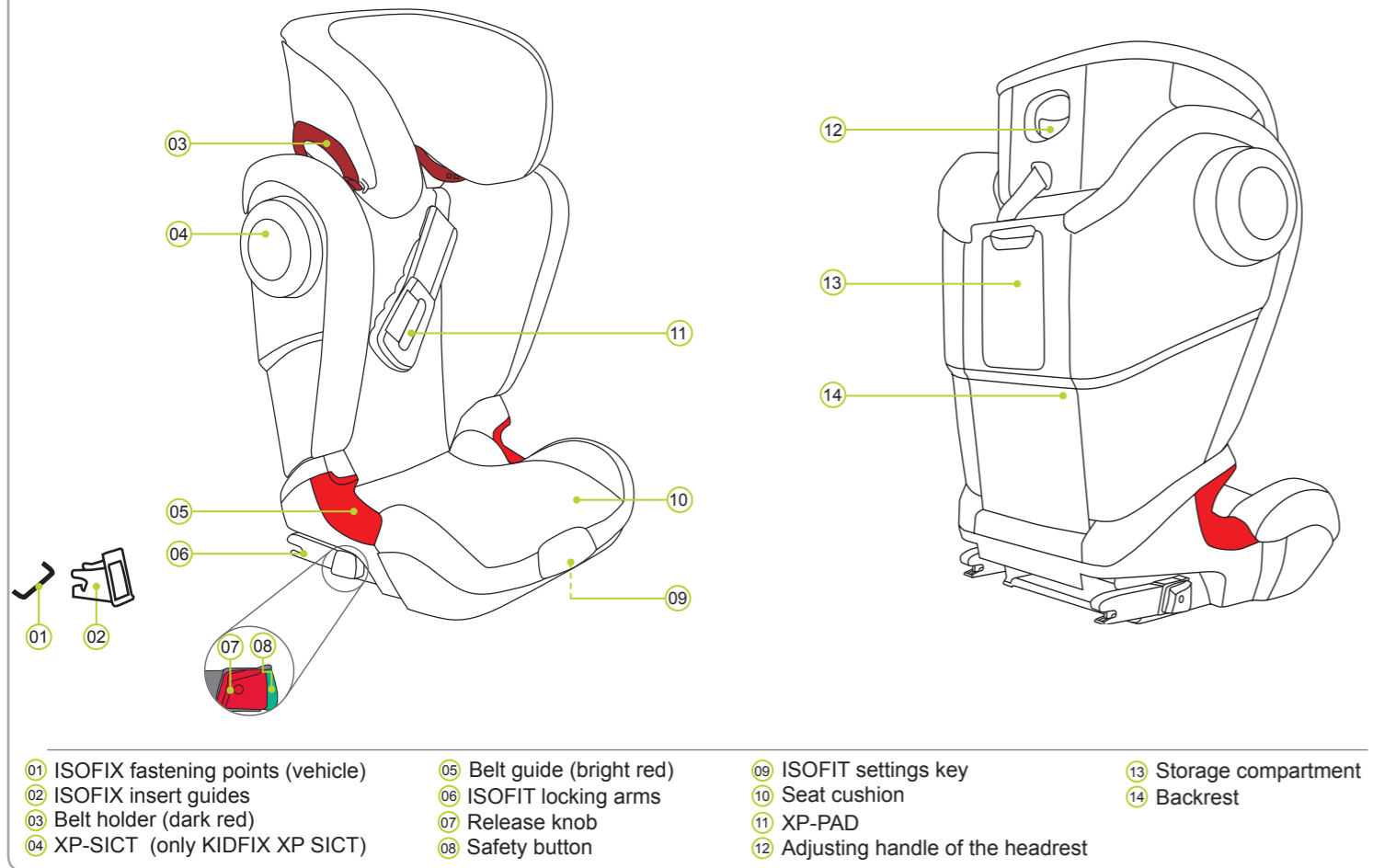

- 01 ISOFIX fastening points (vehicle)
- 02 ISOFIX insert guides
- 03 Belt holder (dark red)
- 04 XP-SICT (only KIDFIX XP SICT)
- 05 Belt guide (bright red)
- 06 ISOFIT locking arms
- 07 Release knob
- 08 Safety button
- 09 ISOFIT settings key
- 10 Seat cushion
- 11 XP-PAD
- 12 Adjusting handle of the headrest
- 13 Storage compartment
- 14 Backrest

4. USE IN THE VEHICLE

Please observe the instructions for using children's restraining systems in the operating instructions of your vehicle. The seat can be used in vehicles with ISOFIX anchoring systems (see type list) and in vehicles with a 3-point belt.

Please find the information on the seats approved for child safety seats of the weight classes 15 to 36 kg in the operating instructions of your vehicle.

The KIDFIX XP / KIDFIX XP SICT is approved for two different methods of installation:

Symbol	Installation type	Approval type	Section
	with the ISOFIT locking arms on the ISOFIX fastening points in the vehicle. Observe the vehicle type list.	semi-universal a)	9A
	with the vehicle's 3-point seatbelt	universal	9B

a) This means that the child safety seat may only be used in vehicles that are listed in the vehicle type list enclosed. This type list is consistently kept up to date. The latest version can be obtained from us or from www.britax.eu / www.roemer.eu.

You can use your child safety seat as follows:

In the direction of travel	Yes
Against the direction of travel	no ¹⁾
with 2-point belt	no
with 3-point belt ²⁾	Yes
with ISOFIX fastening points (between seat surface and backrest)	Yes
on front passenger seat	Yes ³⁾
on outer rear seat	Yes
on centre rear seat (with 3-point belt)	Yes ⁴⁾

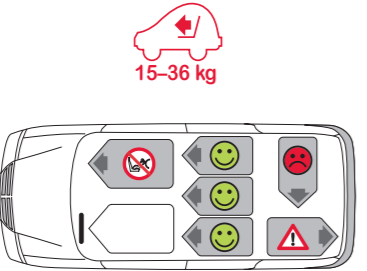

- 1) Use is permitted on a rearward-facing vehicle seat (e.g. in a van or minibus) only if the vehicle seat is also approved for use by adults. The seat may not be in the area of effect of an airbag.
- 2) The safety belt must be approved to ECE R 16 or a comparable standard (see test label on belt with an "E" or "e" in a circle).
- 3) If there is a front airbag: Slide the vehicle seat a long way back and refer to any instructions in vehicle owner's manual.
- 4) Cannot be used if the vehicle seat is equipped with only a 2-point belt.

5. CARE AND MAINTENANCE

Please ensure that you only use the original BRITAX RÖMER replacement seat covers, as the seat cover is an integral part of the child safety seat and fulfils important functions to ensure the smooth operation of the system. Replacement seat covers are available from your dealer or from an ADAC office.

- The cover can be removed and washed with a mild detergent in the delicates programme of the washing machine (30 °C). Please observe the instructions on the washing label of the cover.
- The plastic parts and the XP-PAD can be cleaned with a soap sud. Do not use any caustic cleaning agents (such as solvents).

⚠ DANGER! The child seat must not be used without the seat cover.

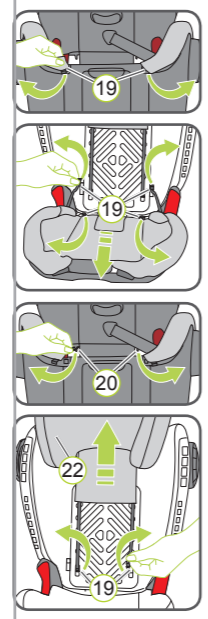

- Removing the seat cover**
1. Moving the headrest of the vehicle seat into the top position.
 2. Unhook the cover hook (19) on the rear of the backrest.
 3. Remove the top part of the cover and fold it forwards to the seat surface.
 4. Unhook the cover hook (19) on the front of the backrest.
 5. Pull the cover off of the seat surface.

- Removing the headrest cover**
6. Unhook the cover loop (20) on the rear of the backrest.
 7. Unhook the cover hook (19) on the front of the backrest.
 8. Pull off the cover of the headrest (22).
- The cover can now be washed. Please observe the instructions on the washing label of the cover:



Re-fitting the cover
Proceed in reverse order to put on the cover.

2. INTRODUCTION

We are delighted that our KIDFIX XP / KIDFIX XP SICT can safely accompany your child through a new stage in its life.

In order to protect your child correctly, the KIDFIX XP/ KIDFIX XP SICT must always be used and installed as described in these instructions.

If you have any further questions regarding its use, please feel free to contact us:

BRITAX RÖMER
Kindersicherheit GmbH
Blaubeurer Straße 71
D-89077 Ulm
Germany
T.: +49 (0) 731 9345-199/-299
F.: +49 (0) 731 9345-210
E.: service.de@britax.com
www.britax.eu

BRITAX EXCELSIOR LIMITED
1 Churchill Way West
Andover
Hampshire SP10 3UW
United Kingdom
T.: +44 (0) 1264 333343
F.: +44 (0) 1264 334146
E.: service.uk@britax.com
www.britax.eu

These instructions use the following symbols stated below:

Symbol	Keyword	Explanation
	DANGER!	Risk of severe personal injury
	WARNING!	Risk of minor personal injury
	CAUTION!	Risk of material damage
	TIP:	Useful notes

Instructions that follow a set sequence are numbered.
Example:

1. Press the button...

Belt guide colours

For better differentiation, the two vehicle seat belts are highlighted in different colours. The diagonal seat belt (16) in dark red and the lap belt (15) in bright red. The colour of the belt guides on the child safety seat follows the same colour scheme.

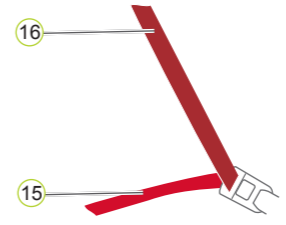

6. DISASSEMBLY AND DISPOSAL

UNFASTENING YOUR CHILD:

1. To unfasten your child, use the release button of your vehicle seat buckle.
- ⓘ TIP!** The XP-PAD can remained applied for easier use on the diagonal belt of your vehicle, the diagonal belt must be retensioned before every journey; see: Section 10 step 12 [page II].

REMOVAL:

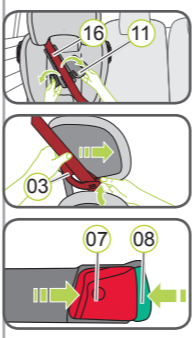

1. Operate the release key of your vehicle seat buckle
 2. Open the XP-PAD (11) on the Velcro fastener and remove the diagonal belt (16).
 3. Open the dark red belt holder (03) by pressing backwards the key on the belt holder (03) and unthreading the diagonal belt (16).
Only for installation type A (ISOFIT):
 4. To release the ISOFIT fastening, release the green safety button (08) and the red release button (07) first on the one and the on the other side opposite on another.
- The child safety seat can now be removed.

⚠ DANGER! the child safety seat must always be secured when it is in the vehicle, even if no child is being transported.

DISPOSAL:

Please observe the waste disposal regulations in your country.

Disposal of packaging	Container for cardboard boxes
Seat cover	Residual waste, thermal utilisation
Plastic parts	According to the labelling in the corresponding container
Metal parts	Container for metals
Belt straps	Container for polyester
buckle and tongue	Residual waste

3. Certification

BRITAX RÖMER Child safety seat	Testing and certification In accordance with ECE* R 44/04	
	Group	Body weight
KIDFIX XP	II+III	15 to 36 kg
KIDFIX XP SICT		

*ECE = European Standard for Child Safety Equipment

The child safety seat has been designed, tested and certified according to the requirements of the European Standard for Child Safety Equipment (ECE R 44/03). The seal of approval E (in a circle) and the approval number are located on the orange approval label (sticker on the child safety seat).

⚠ DANGER! This approval will be invalidated if you make any modifications to the child safety seat. Only the manufacturer is permitted to make modifications to the child safety seat. The child seat is approved for use both with and without XP-PAD.

⚠ WARNING! Use the KIDFIX XP / KIDFIX XP SICT exclusively for securing your child in your vehicle. It is in no way suitable as a seat or toy in the home.

⚠ DANGER! Never secure your child or the child safety seat with a 2-point belt. If you secure your child in the child seat with only a 2-point belt, then in the event of an accident this may cause serious injuries to your child, possibly resulting in death.

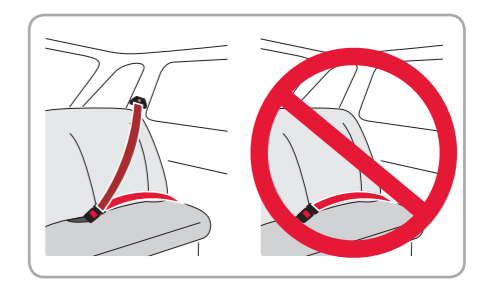

15 kg - 36 kg
 (~4 Y - 12 Y)



KIDFIX XP
KIDFIX XP SICT

GB

User instructions



7. SAFETY NOTES

⚠ Please take the time to read these instructions carefully and keep them to hand in the intended storage compartment 13 on the child safety seat at all times! The instructions must be with the child safety seat if the latter is passed on to a third party.

⚠ DANGER! For the protection of your child:

- In the event of an accident with a collision speed of more than 10 km/h, the child safety seat may be damaged without the damage becoming immediately visible. In this case the child safety seat must be replaced. Please dispose of it properly.
- Have your child safety seat checked as a rule if it was damaged (e.g. if it falls to the ground).
- Regularly check all important parts for damage. Ensure that all mechanical parts, in particular, are fully functional.
- Never lubricate or oil parts of the child seat.
- Never leave your child unattended in the child seat in the vehicle.
- Let your child in and out of the vehicle from the pavement side as a rule.
- Protect the child safety seat against intensive direct sun radiation, as long as it is not in use. The child safety seat can become very hot under direct sun radiation. Child skin is sensitive and could thereby be injured.
- The more snugly the harness fits over your child's body, the better your will be protected. Therefore avoid putting thick clothes on your child under the belt.
- Take regular breaks on long journeys in order to give your child the opportunity to play around.
- Use on the rear seat: Push the front seat forwards sufficiently so that the feet of your child do not hit the backrest of the front seat (to avoid the risk of injury).

⚠ DANGER! For the protection of all vehicle occupants:

- In the case of an emergency stop or an accident, unsecured persons or objects may cause injury to other vehicle occupants. Please always check that...
- the backrests of the vehicle seats are locked (i.e. that a foldable rear seat bench latch is engaged).
 - all heavy or sharp-edged objects in the vehicle (e.g. on the parcel shelf) are secured.
 - all persons in the vehicle have their seatbelts fastened.
 - the child safety seat is always secured when it is in the vehicle, even if no child is being transported.

⚠ WARNING! For your protection when handling the child seat:

- Never use the child safety seat free-standing, not even for test sitting.
- When swivelling up the backrest 14, nothing must come between the backrest 14 and the seat cushion 10. You or your child could pinch your fingers, injuring them.
- To avoid damage, ensure that the child safety seat is not jammed in between hard objects (car door, seat rails, etc.).
- Keep the child safety seat in a safe place if it is not in use. Do not place any heavy objects on the seat and do not store it directly next to sources of heat or in direct sunlight.

⚠ CAUTION! To protect your vehicle:

- Certain car seat covers made from more sensitive materials (e.g. velour, leather, etc.) may sustain signs of wear and tear when using child safety seats. For the optimum protection of your car seat covers, we recommend using the BRITAX RÖMER child safety seat surface from our accessories programme.

8. ADJUSTING THE HEADREST

A correctly set headrest 22 ensures that the diagonal seat belt section 16 is optimally positioned, and gives your child optimum protection. The headrest 22 must be adjusted so that there is a space two fingers wide between the headrest 22 and your child's shoulders.

To adjust the height of the headrest to fit your child:

1. Reach into the adjustment handle 12 on the back of the headrest 22 and pull it towards you. This unlocks the headrest.
2. You can now move the unlocked headrest 22 to the desired height. As soon as you release the adjustment handle 12, the headrest 22 will lock into place.
3. Place the child safety seat on the vehicle seat.
4. Have your child sit down in the child safety seat and check the height. Repeat the procedure until the headrest 22 has the correct height.

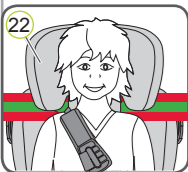
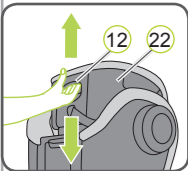

9. INSTALLATION

A With ISOFIT + 3-point belt

The KIDFIX XP / KIDFIX XP SICT is installed permanently in the vehicle with the ISOFIT locking arms.

Your child is then buckled into the child seat with the vehicle's 3-point seatbelt.



1. If your vehicle is not fitted with ISOFIX insert guides by standard, clamp the two insert guides 02, which are included in the scope of delivery of the seat*, with the section pointing upwards to the two ISOFIX fastening points 01 of your vehicle.

ⓘ TIP! The ISOFIX fastening points are located between the surface and the backrest of the vehicle seat.

* The insert guides facilitate the installation of the child safety seat with the use of the ISOFIX fastening points and prevent damage to the car seat covers. As long as they are not used, remove them and keep them in a safe place. For vehicles with foldable a backrest, the insert guides need to be removed before folding the backrest. Any problems occurring usually come from soiling or external objects on the insert guides and on the hook. Remove soiling or external objects to rectify such problems.

2. Moving the headrest of the vehicle seat into the top position.
3. Carry out the steps in Section 8 „ADJUSTING THE HEADREST“.
4. Hold the ISOFIT settings button 09 down and push the ISOFIT locking arms 06 out in full .

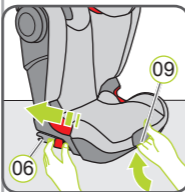

5. Push the green safety button 08 and the red release button 07 on both sides of the seat towards each other. This ensures that both hooks on the ISOFIT locking arms 06 are open and ready to use.

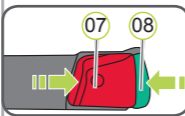

6. Place the XP-PAD 11 on the side of the child safety seat closer to the vehicle door.



7. Guide the elastic holding strap of the XP-PAD 11 into the dark red belt holder 03 of the headrest 22 until it lies completely in the belt holder 03 and is not twisted.

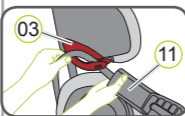

8. Place the child safety seat in driving direction on a vehicle seat approved for use. Ensure that the backrest 14 is flush with the backrest of the vehicle seat .



9. Position the two ISOFIT locking arms 06 directly in front of the two insert guides 02.



10. Push both ISOFIT locking arms 06 into the insert guides 02 until the ISOFIT locking arms 06 engage on both sides with a clicking sound.

⚠ DANGER! The green safety button 08 must be visible on both sides so that the child safety seat is correctly fastened.

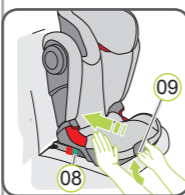

11. Hold the ISOFIT settings button 09 down and push the child safety seat as far back as possible.



12. Shake the child safety seat to ensure that it is securely fastened and check again the fastening buttons 08 to ensure that both are fully green.
13. Carry out the steps in Section 10 „SECURING YOUR CHILD“.

⚠ For the safety of your child, before every journey in the car check that...

- ▶ the child safety seat is slotted in on both sides with the ISOFIT locking arms 06 in the ISOFIT fastening points 01 and both safety buttons 08 are fully green;
- ▶ the child safety seat is securely fastened;
- ▶ the lap belt 15 runs in the bright red belt guides on both sides of the seat cushion 05,
- ▶ the diagonal seat belt section 16 on the side of the vehicle seatbelt buckle 18 also runs through the light red belt guide 05 of the seat cushion,
- ▶ the diagonal seat belt section 16 runs through the dark red belt holder 03 of the headrest,
- ▶ XP-PAD 11 and XP-SICT 04 are correctly installed and used,
- ▶ the diagonal seat belt section 16 runs diagonally backward,
- ▶ the straps are tight and not twisted,
- ▶ The seatbelt buckle 18 must not be positioned on the red belt guide 05 in the seat cushion.

⚠ DANGER! If your child tries to open the ISOFIX safety buttons 08 or the vehicle belt buckle 18, stop immediately as soon as possible. Check whether the child safety seat is correctly fastened and ensure that your child is correctly secured. Explain to your child the dangers associated with his actions.

UNFASTENING YOUR CHILD AND REMOVAL:

To unfasten your child or to remove the child safety seat, observe the steps in Section 6 „REMOVAL“ [PAGE I]

B With 3-point belt

The KIDFIX XP / KIDFIX XP SICT is not installed permanently in the vehicle. It is simply secured together with your child using the vehicle's 3-point seatbelt.



1. Carry out the steps in Section 8 „ADJUSTING THE HEADREST“.
2. Place the XP-PAD 11 on the side of the child safety seat closer to the vehicle door.
3. Guide the elastic holding strap of the XP-PAD 11 into the dark red belt holder 03 of the headrest 03 until it lies completely in the belt holder 03 and is not twisted.
4. Place the child seat on the vehicle seat. Ensure that the backrest 14 is flush with the backrest of the vehicle seat.

ⓘ Tip! If the headrest of the vehicle seat gets in the way, turn it the other way.

5. Carry out the steps in Section 10 „SECURING YOUR CHILD“.

⚠ For the safety of your child, before every journey in the car check that...

- ▶ the child safety seat is securely fastened;
- ▶ the lap belt 15 runs in the bright red belt guides on both sides of the seat cushion 05,
- ▶ the diagonal seat belt section 16 on the side of the vehicle seatbelt buckle 18 also runs through the light red belt guide 05 of the seat cushion,
- ▶ the diagonal seat belt section 16 runs through the dark red belt holder 03 of the headrest,
- ▶ the diagonal seat belt section 16 runs diagonally backward,
- ▶ the straps are tight and not twisted,
- ▶ XP-PAD 11 and XP-SICT 04 are correctly installed and used,
- ▶ the seatbelt buckle 18 must not be positioned on the red belt guide 05 in the seat cushion.

⚠ DANGER! If your child tries to open the vehicle belt buckle 18, stop immediately as soon as possible. Check whether the child safety seat is correctly fastened and ensure that your child is correctly secured. Explain to your child the dangers associated with his actions.

UNFASTENING YOUR CHILD AND REMOVAL:

To unfasten your child or to remove the child safety seat, observe the steps in Section 6 „REMOVAL“ [PAGE I]

10. SECURING YOUR CHILD

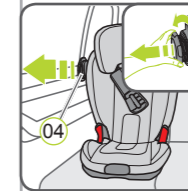

KIDFIX XP SICT:

Unscrew the XP-SICT 04 anti-clockwise (on the side closer to the vehicle door) until it has a distance of 5 mm to the vehicle door or has been unscrewed to the maximum.



KIDFIX XP SICT & KIDFIX XP:

1. Let your child sit in the child safety seat and place the XP-PAD 11 over the chest area of your child. If you find that the retraction force of the 3-point seat belt is not enough to ensure that the seat belt is tight (against the child), the child seat can be used without XP-PAD 11; see Chapter 3 „APPROVAL“ [PAGE I].

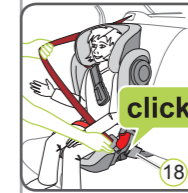

2. Pull out the vehicle belt and guide it in front of your child to the vehicle seat buckle 18.

⚠ DANGER! Ensure the vehicle belt is not twisted, as otherwise the full protective effect of the retaining system is not ensured.

3. Engage the buckle tongue in the vehicle seat buckle 18 with a CLICK!



4. Place the diagonal seat belt section 16 and lap belt section 15 on the side of the vehicle seatbelt buckle 18 into the light red belt guide 05 of the seat cushion.

⚠ DANGER! The vehicle seatbelt buckle 18 must not be positioned between the light red belt guide 05 and the armrest.



5. Also place the lap belt section 15 on the other side of the seat cushion in the light red belt guide 05.

⚠ DANGER! The lap belt section 15 must lie as low as possible over your child's hips on both sides.

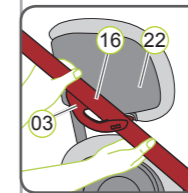

6. Guide the diagonal seat belt section 16 into the dark red belt holder 03 of the headrest 22 until it lies completely in the belt holder 03 and is not twisted.

ⓘ Tip! If the backrest 14 conceals the belt holder 03, you can adjust the headrest 22 upwards. The diagonal seat belt section 16 can now be easily inserted. Now return the headrest 22 to the proper height.

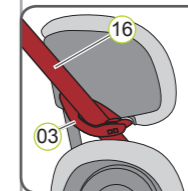

7. Ensure that the diagonal belt 16 runs over the collarbone of your child and is not on the neck and that the key on the belt holder is 03 fully closed.

ⓘ Tip! You can still adjust the height of the headrest 22 again here in the vehicle.

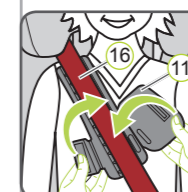

8. Open the Velcro fastener on the XP-PAD 11 and fold the top part of the XP-PAD 11 to the side.

9. Insert the diagonal belt 16 in the die nubby surface of the XP-PAD 11.

10. Close the XP-PAD 11 again by folding the folded part back and closing the Velcro fastener.

⚠ DANGER! The diagonal seat belt section 16 must run diagonally backward. You can adjust the course of the belt with your vehicle's adjustable belt deflector.

⚠ DANGER! The diagonal belt 16 must never be directed forwards to the belt deflector on the vehicle. In this case, use the child safety seat on the back seat only.

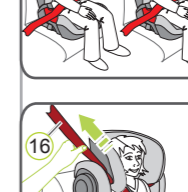

11. Tighten the vehicle seat belt by pulling on the diagonal seat belt section 16.

12. Observe the further steps of the relevant installation type.